

DRAWING A SIMPLE "HOUSE" STEP-BY-STEP INSTRUCTIONS

FIRST, BEGIN BY DRAWING A "HORIZON" LINE ACROSS THE TOP OF YOUR PAPER. NEXT, PLACE VANISHING POINTS AT THE ENDS OF THE HORIZON LINE.

- THE 1ST LINE OF YOUR HOUSE ① IS THE CORNER NEAREST TO THE VIEWER. MAKE SURE THIS LINE IS TALL ENOUGH TO REACH THE PEAK OF THE ROOF!
- DRAW RECEDING LINES ②③④ & ⑤ FROM LINE ① TO BOTH VANISHING POINTS.
- DRAW THE LEFT END ⑥ OF YOUR HOUSE BETWEEN LINES ④ AND ⑤
- DRAW THE RIGHT END ⑦ OF YOUR HOUSE BETWEEN LINES ② AND ③
(BE SURE TO MAKE LINE ⑦ CLOSER TO LINE ① THAN LINE ⑥)

NOW, DECIDE HOW TALL YOU WANT YOUR ROOF TO BE $\frac{1}{2}$ PUT POINT "A" ON LINE ①.

- DRAW RECEDING LINES ⑧ AND ⑨ FROM POINT "A" TO BOTH VANISHING POINTS. FIND THE "VISUAL CENTER" OF THE FRONT OF THE HOUSE BY DRAWING AN "X".
- DRAW LINE ⑩ FROM THE TOP OF LINE ① TO THE BOTTOM OF LINE ⑦
- DRAW LINE ⑪ FROM THE TOP OF LINE ⑦ TO THE BOTTOM OF LINE ①
- DRAW LINE ⑫ SO IT PASSES THROUGH THE CENTER OF YOUR "X".
(LINE ⑫ IS DRAWN BETWEEN LINES ② AND ③.)

PLACE POINT "B" ON LINE ②, AT THE TOP OF LINE ⑫

- DRAW LINE ⑬ FROM POINT "B" TO THE LEFT VANISHING POINT.
 - DRAW LINE ⑭ FROM THE TOP OF LINE ⑥ TO THE RIGHT VANISHING POINT.
- PLACE POINT "C" ON LINE ⑭ WHERE LINE ⑬ CROSSES ⑭.
- DRAW LINE ⑮ FROM POINT "A" TO POINT "B".
 - DRAW LINE ⑯ FROM POINT "B" TO THE PLACE WHERE LINE ⑦ CROSSES ⑧.
 - DRAW LINE ⑰ FROM POINT "C" TO THE PLACE WHERE LINE ⑨ CROSSES ⑥.

NOW, JUST DARKEN THE OUTLINE, ERASE ALL THE EXTRA LINES, AND YOU'LL BE READY TO ADD WINDOWS, A DOOR AND SIDING.

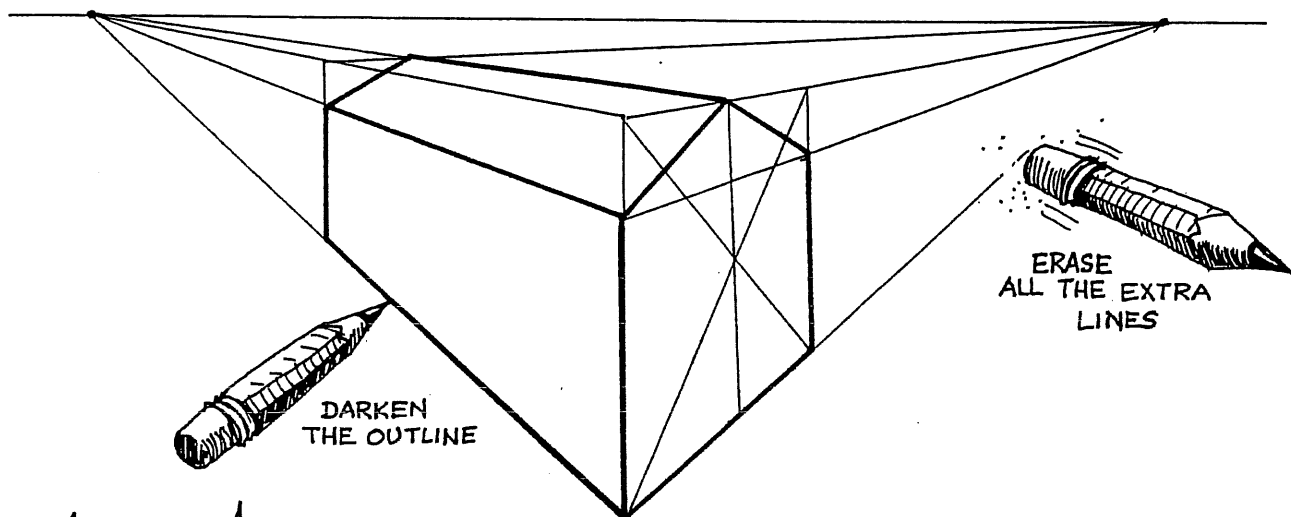

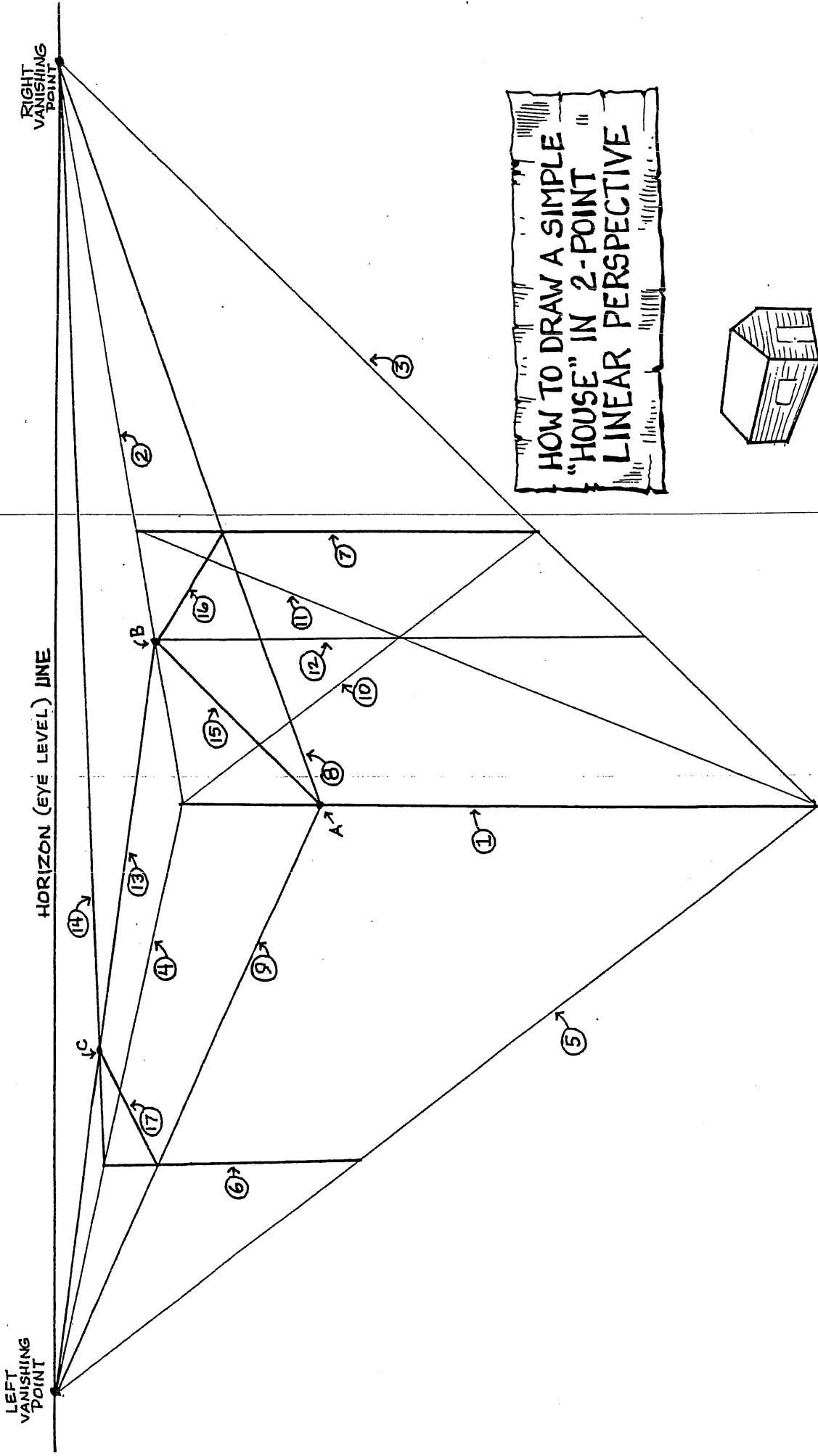

HOW TO DRAW A SIMPLE "HOUSE" IN 2-POINT LINEAR PERSPECTIVE

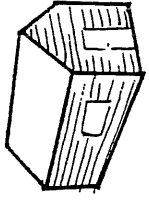

ADDING DETAILS TO YOUR SIMPLE "HOUSE"

← VANISHING POINT 1 (VP1)

USING A RULER, DIVIDE THE CENTER LINE INTO EQUAL SPACES.

NEXT, DRAW LINES FROM EACH DIVISION MARK TO THE VANISHING POINTS TO SHOW SIDING.

VANISHING POINT 2 (VP2) →

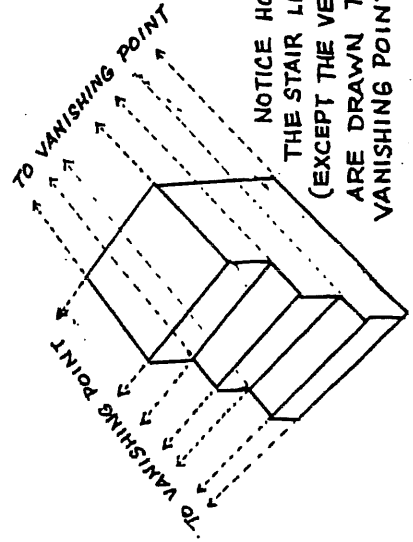
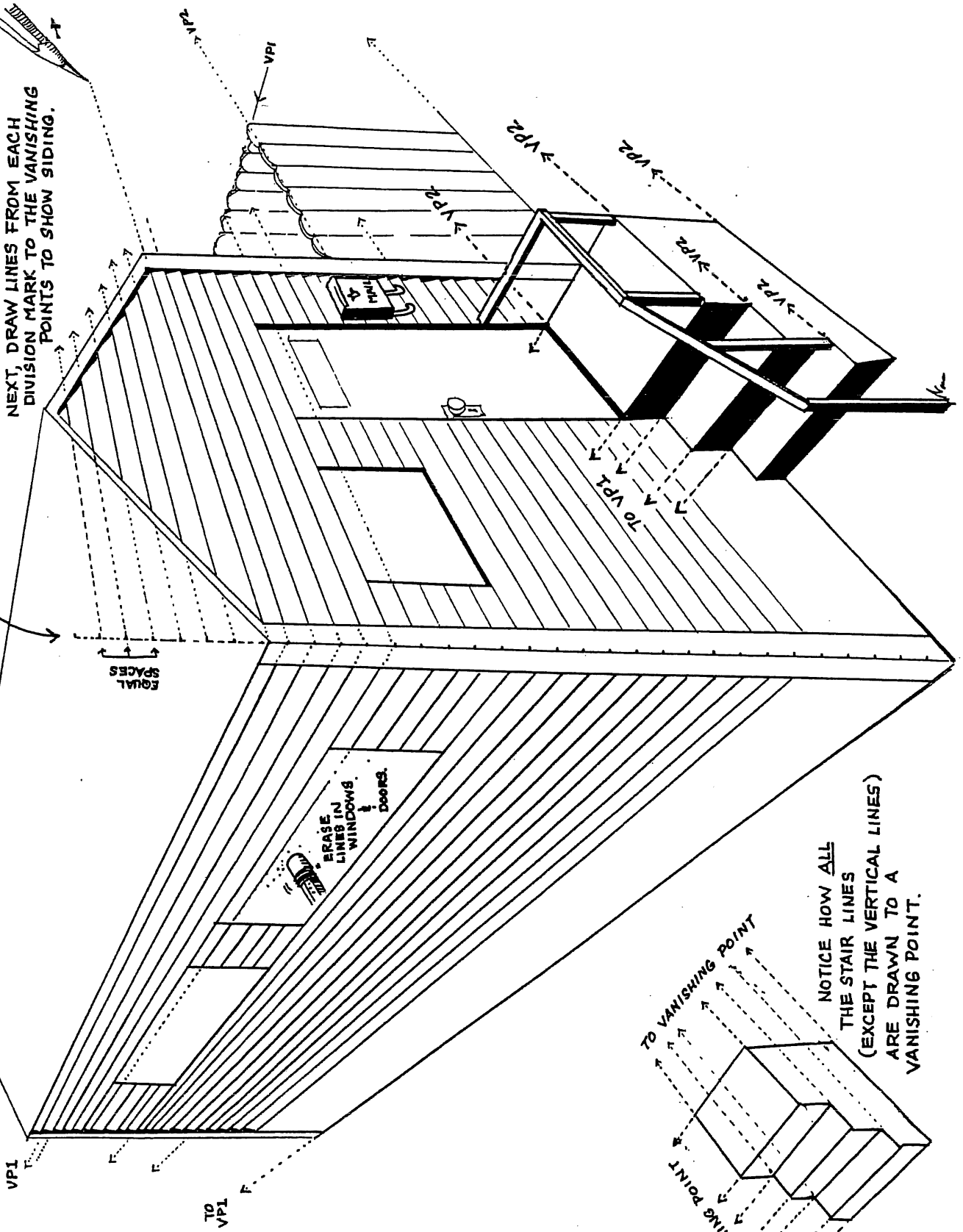

NOTICE HOW ALL THE STAIR LINES (EXCEPT THE VERTICAL LINES) ARE DRAWN TO A VANISHING POINT.

DESIGNING AND DRAWING A 2-POINT PERSPECTIVE VIEW FROM A BALCONY

DRAWING BY
THE NUMBERS...

START HERE



1. BEGIN BY DRAWING
A HORIZON LINE
THROUGH THE CENTER
OF YOUR PAPER.

ADD VANISHING POINTS (V.P.)
TO EACH END.

V.P.

HORIZON LINE

V.P.

2. NEXT, USING
THE VANISHING
POINTS (V.P.)
DRAW THE
BALCONY IN THE
CORNER OF
YOUR PAPER.

5. WORK YOUR WAY
TOWARDS THE VANISHING
POINTS, ADDING BUILDINGS
ALONG THE WAY.

4. THE FIRST BUILDING YOU DRAW
SHOULD BE THE ONE ON THE
CORNER.

3. DRAW THE SIDEWALK
FROM THE CORNER TO
THE VANISHING POINTS.

6. PLACE TALL
BUILDINGS (USING
THE SAME VANISHING
POINTS)
IN THE BACKGROUND.

